



134 Dale View Crescent, Chingford, London, E4 6PG

Offers In Excess Of £725,000

3 Bedrooms / 2 Receptions / 1 Bathrooms

1136.00 sq ft

House - Semi-Detached

Council Tax Band: E

Local Authority:

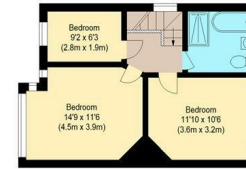

First Floor



Ground Floor

william rose
Dale View Crescent, E4

Approximate Gross Internal Floor Area : 105.53 sq m / 1136 sq ft
Garage/ Out House : 36.14 sq m/ 389 sq ft



Measured according to RICS IPMS2. Floor plan is for illustrative purposes only and is not to scale. Every attempt has been made to ensure the accuracy of the floor plan shown, however all measurements, fixtures, fittings and data shown are an approximate interpretation for illustrative purposes only. 1 sq m = 10.76 sq feet.

Date: 28/2/2025



Key Features:

- 1930s semi-detached family home
- Extended to the rear
- Three well-proportioned bedrooms
- Bright and airy living space
- Private driveway and garage
- Generous rear garden with a versatile summer house
- Potential for further development (STPP)
- Sought-after location
- Close to excellent schools
- Move-in ready



| Energy Efficiency Rating | | |
|---|-------------------------|-----------|
| | Current | Potential |
| Very energy efficient - lower running costs | | |
| (92 plus) A | | 87 |
| (81-91) B | | |
| (69-80) C | | |
| (55-68) D | 68 | |
| (39-54) E | | |
| (21-38) F | | |
| (1-20) G | | |
| Not energy efficient - higher running costs | | |
| England & Wales | EU Directive 2002/91/EC | |

